

**vtech**<sup>®</sup>

User's Manual

# Alphabet Apple



© 2013 VTech  
Printed in China  
91-002354-015 UK

**VTech understands that a child's needs and abilities change as they grow and with that in mind we develop our toys to teach and entertain at just the right level...**

## **vtech** Baby

**Toys that will stimulate their interest in different textures, sounds and colours**

### **I am...**

...responding to colours, sounds and textures

...understanding cause and effect

...learning to touch, reach, grasp, sit-up, crawl and toddle

*Birth-36months*



## **Pre-School**

**Interactive toys to develop their imagination and encourage language development**

### **I want...**

...to get ready for school by starting to learn the alphabet and counting

...my learning to be as fun, easy and exciting as can be

...to show my creativity with drawing and music so my whole brain develops

*3-6years*



## **Electronic Learning Computers**

**Cool, aspirational and inspiring computers for curriculum related learning**

### **I need...**

...challenging activities that can keep pace with my growing mind

...intelligent technology that adapts to my level of learning

...National Curriculum based content to support what I'm learning at school

*4-10years*



To learn more about this and other VTech® products, visit [www.vtechuk.com](http://www.vtechuk.com)

# INTRODUCTION

Thank you for purchasing the **VTech® Alphabet Apple**.

This **VTech® Alphabet Apple** is an interactive light-up learning board that's full of fun! The big green light-up worm introduces twenty-six letter buttons and a moveable clock hand that encourages exploration and discovery. The Apple teaches essential pre-school curriculum including phonics, letters, numbers, spelling, songs, vocabulary and time concepts. Realistic sounds effects, light-up buttons, fun phrases, different levels of play and cheerful melodies add to the overall learning experience!



## INCLUDED IN THIS PACKAGE

- One **VTech® Alphabet Apple**
- One User's manual

**WARNING:** All packing materials, such as tape, plastic sheets, packaging locks and tags are not part of this toy and should be discarded for your child's safety.

**NOTE:** Please keep the user's manual as it contains important information.

### Unlock the packaging locks:

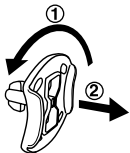

- ① Rotate the packaging locks 90 degrees counter-clockwise.
- ② Pull out the packaging locks.

## GETTING STARTED

### BATTERY INSTALLATION

1. Make sure the unit is turned **OFF**.
2. Locate the battery cover on the bottom of the unit.
3. Use a coin or screwdriver to loosen the screw and open the battery cover.
4. Install 2 new AA (AM3/LR6) batteries into the battery box as illustrated. (The use of new, alkaline batteries is recommended for maximum performance.)
5. Replace the battery cover and tighten the screw to secure.

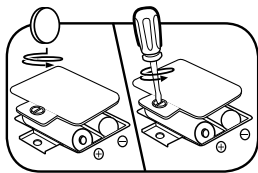

### BATTERY NOTICE

- Use new alkaline batteries for maximum performance.
- Use only batteries of the same or equivalent type as recommended.
- Do not mix different types of batteries: alkaline, standard (carbon-zinc) or rechargeable (Ni-Cd, Ni-MH), or new and used batteries.
- Do not use damaged batteries.
- Insert batteries with the correct polarity.
- Do not short-circuit the battery terminals.
- Remove exhausted batteries from the toy.
- Remove batteries during long periods of non-use.
- Do not dispose of batteries in fire.

- Do not charge non-rechargeable batteries.
- Remove rechargeable batteries from the toy before charging (if removable).
- Rechargeable batteries are only to be charged under adult supervision.

## Disposal of batteries and product



The crossed-out wheellie bin symbols on products and batteries, or on their respective packaging, indicates they must not be disposed of in domestic waste as they contain substances that can be damaging to the environment and human health.



The chemical symbols Hg, Cd or Pb, where marked, indicate that the battery contains more than the specified value of mercury (Hg), cadmium (Cd) or lead (Pb) set out in Battery Directive (2006/66/EC).

The solid bar indicates that the product was placed on the market after 13th August, 2005.

Help protect the environment by disposing of your product or batteries responsibly.

For more information, please visit:

[www.recycle-more.co.uk](http://www.recycle-more.co.uk)

[www.recyclenow.com](http://www.recyclenow.com)

## PRODUCT FEATURES

### 1. ON/OFF BUTTON

To turn the unit ON, press the **ON/OFF BUTTON**.  
To turn the unit OFF, press the **ON/OFF BUTTON** again.



### 2. LIGHT-UP WORM SLIDER

Push the **WORM SLIDER** at any time to hear a fun sing-along song sung by the worm and watch the flashing light patterns.

There are 3 songs that the worm will sing:

- Sing-along song 1: The Alphabet Song  
Sing-along song 2: Hickory Dickory Dock  
Sing-along song 3: Glow Worm

### 3. ACTIVITY SLIDER

Slide the **ACTIVITY SLIDER** up or down to select an activity to play.

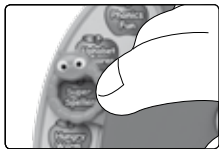

### 4. LIGHT-UP LETTER BUTTONS

Press the **LETTER BUTTONS** to learn letters, phonics, objects, play music and to answer the fun questions!



### 5. LIGHT-UP HELP BUTTON

Press the **HELP BUTTON** to repeat the current question or give a helpful hint.



### 6. MOVEABLE CLOCK HAND

Move the **CLOCK HAND** at any time to hear the corresponding time and a related phrase or answer a question in the Quiz Time activity.



### VOLUME CONTROL SWITCH

Located on the back of the product, the **VOLUME CONTROL SWITCH** can be moved to the right for higher volume or to the left for lower volume.

## AUTOMATIC SHUT-OFF

To preserve battery life, the **VTech® Alphabet Apple** will automatically power-down after approximately one minute without input. The unit can be turned on again by pressing the On/Off **BUTTON**.

## TO BEGIN PLAY

Press the **ON/OFF BUTTON** to turn on the unit, then move the **ACTIVITY SLIDER** to select a game to play.

**Note: Make sure the ACTIVITY SLIDER is positioned on one of the seven activities. If you accidentally move the ACTIVITY SLIDER between two activity modes, the worm will ask you to move the slider to select a game.**

## ACTIVITIES:

The **VTech® Alphabet Apple** offers a total of 8 activities to play.

### Activity 1 : Phonics Fun

Move the **ACTIVITY SLIDER** to the first position to enter this activity. You will be asked to press any **LETTER BUTTON** to learn about letter sounds. Keep pressing the buttons to learn more letter sounds.

### Activity 2: Alphabet Explorer

Move the **ACTIVITY SLIDER** to the second position to enter this activity. You will be asked to press any **LETTER BUTTON** to learn about vocabulary words. Press any letter button to hear a word that begins with that letter.

### Activity 3: Super Speller

Move the **ACTIVITY SLIDER** to the third position to enter this activity. You will hear a word and how it is spelt. Watch carefully as the buttons light-up to spell the word, then press the **LETTER BUTTONS** in the correct order to spell the word. There are four difficulty levels in this activity. After every five words are spelt correctly, it will automatically move up to the next level of words.

### Activity 4: Hungry Worm

Move the **ACTIVITY SLIDER** to the fourth position to enter this activity. The worm is hungry! You will be asked to press the flashing apples to feed the hungry worm. There are five difficulty levels in this mode.

### **Activity 5: Follow the Lights**

Move the ACTIVITY SLIDER to the fifth position to enter this activity. This is a memory game. Watch as the buttons light-up and then repeat the pattern. A new light will be added to the sequence after each correct round. There are a total of three difficulty levels.

### **Activity 6: Quiz Time**

Move the ACTIVITY SLIDER to the sixth position to enter this activity. You will be asked a series of fun quiz questions. Press a LETTER BUTTON or move the CLOCK HAND to answer questions.

Level 1: Find the letter.

Level 2: Find the object.

Level 3: Find the time.

Level 4: Find the letter sound.

Level 5: Find the letter order.

### **Activity 7: Music Party**

Move the ACTIVITY SLIDER to the seventh position to enter this activity. Press any of the LETTER BUTTONS to hear fun melodies. The lights will dance with the music! Press a letter button at any time to change the melody.

### **Activity 8: Clock**

Move the clock hand at any time to hear the corresponding time and a fun related phrase.

## **CARE & MAINTENANCE**

1. Keep the unit clean by wiping it with a slightly damp cloth.
2. Keep the unit out of direct sunlight and away from any direct heat sources.
3. Remove the batteries when the unit is not in use for an extended period of time.
4. Do not drop the unit on a hard surface and do not expose the unit to excess moisture.



# TROUBLESHOOTING

If for some reason the program/activity stops working then please follow these steps:

1. Turn the unit OFF.
2. Interrupt the power supply by removing the batteries.
3. Let the unit stand for a few minutes then replace the batteries.
4. Turn the unit back ON. The unit will now be ready to play again.
5. If the unit still does not work, replace with an entire set of new batteries.

If the problem persists, please call our Consumer Services Department on 01235 546810 (from UK) or +44 1235 546810 (outside UK) and a service representative will be happy to help you.

## IMPORTANT NOTE:

Creating and developing **VTech®** products is accompanied by a responsibility that we at **VTech®** take very seriously. We make every effort to ensure the accuracy of the information which forms the value of our products. However, errors sometimes can occur. It is important for you to know that we stand behind our products and encourage you to call our Consumer Services Department on 01235 546810 (from UK), or +44 1235 546810 (outside UK) with any problems and/or suggestions that you might have. A service representative will be happy to help you.

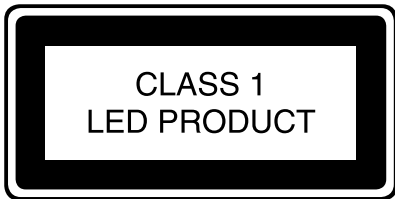



## PRODUCT WARRANTY



Thank you for choosing this quality product from VTech. We hope it will bring many hours of entertainment, imaginative play and learning.

1. The product detailed above is covered by a one year warranty from the date of purchase, against any defects in materials or workmanship.
2. The product may be returned to the place of purchase. Alternatively the product can be returned to VTech Electronics Europe plc (see address below), with proof of purchase, without proof of purchase no replacement will be provided.
3. VTech Electronics Europe plc will examine the product and if it is found to be defective due to faulty materials or workmanship, will replace the product at their discretion.
4. If the product covered by this warranty is damaged due to misuse, modification or unauthorised repair, or because of faulty batteries, battery discharge or incorrect electrical connections, then this warranty becomes void.
5. This warranty is personal to the original purchaser and is not transferable.
6. Breakages to the LCD screen are not covered by the warranty.
7. Returns to VTech Electronics Europe plc should include a cheque or postal order for £1.50 towards the cost of return postage and packaging.
8. Products returned to VTech Electronics Europe plc, should be addressed as follows and packed carefully to avoid damage in transit (Please do not include batteries or adaptor).  
Please include details of the fault together with your name and address.

VTech Electronics Europe plc, c/o Tablogix Limited, 200 Milton Park, Abingdon, Oxon OX14 4TA

THIS WARRANTY IS OFFERED AS AN EXTRA BENEFIT AND DOES NOT AFFECT CONSUMERS' STATUTORY RIGHTS.

This warranty is valid for the UK and Eire only. For products purchased outside the UK and Eire, please contact your local distributor or place of purchase.

