

vtech[®]
Baby

User's Manual

Crazy Legs Learning Bug



© 2012 VTech
Printed in China
91-002439-023 

VTech understands that a child's needs and abilities change as they grow and with that in mind we develop our toys to teach and entertain at just the right level...

vtech *Baby*

Toys that will stimulate their interest in different textures, sounds and colours

I am...

...responding to colours, sounds and textures

...understanding cause and effect

...learning to touch, reach, grasp, sit-up, crawl and toddle

Birth-36 months



Pre-School

Interactive toys to develop their imagination and encourage language development

I want...

...to get ready for school by starting to learn the alphabet and counting

...my learning to be as fun, easy and exciting as can be

...to show my creativity with drawing and music so my whole brain develops

3-6 years



Electronic Learning Computers

Cool, aspirational and inspiring computers for curriculum related learning

I need...

...challenging activities that can keep pace with my growing mind

...intelligent technology that adapts to my level of learning

...National Curriculum based content to support what I'm learning at school

4-10 years



To learn more about this and other VTech® products, visit www.vtechuk.com

INTRODUCTION

Thank you for purchasing the **VTech® Crazy Legs Learning Bug** learning toy.

The **VTech® Crazy Legs Learning Bug** is an interactive pull along toy for toddlers of 12 months and up. Six shape sorters slot into the bug's body for fun reactions and interactive phrases, teaching shapes, numbers and objects. Spinning the baby bug encourages play and the rolling design promotes crawling and walking.

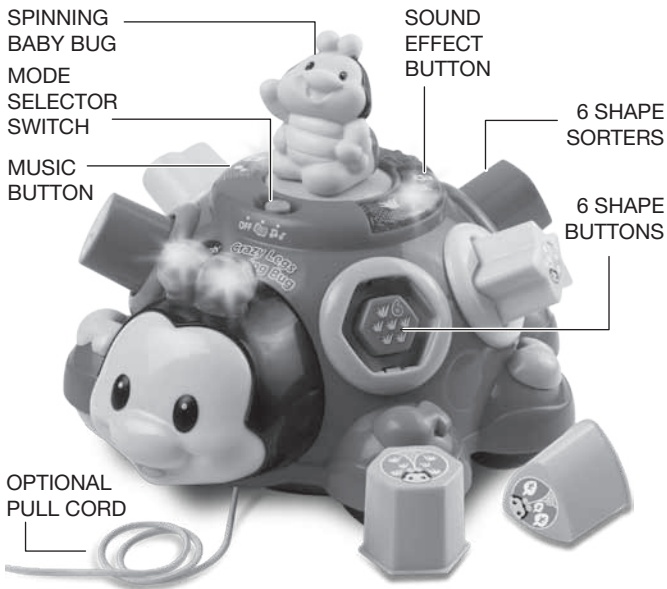

INCLUDED IN THIS PACKAGE

- One **VTech® Crazy Legs Learning Bug** learning toy
- One spinning baby bug
- One instruction manual

WARNING: All packing materials, such as tape, plastic sheets, packaging locks and tags are not part of this toy, and should be discarded for your child's safety.

NOTE: Please keep this instruction manual as it contains important information.

GETTING STARTED

BATTERY INSTALLATION

1. Make sure the unit is turned **OFF**.
2. Locate the battery cover on the bottom of the unit. Use a coin or a screwdriver to loosen the screw.
3. Install 2 new 'AA' (AM-3/LR6) batteries following the diagram inside the battery box. (The use of new alkaline batteries is recommended for maximum performance.)
4. Replace the battery cover and tighten the screw to secure.

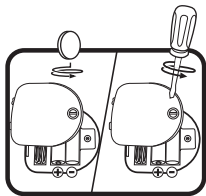

BATTERY NOTICE

- Use new alkaline batteries for maximum performance.
- Use only batteries of the same or equivalent type as recommended.
- Do not mix different types of batteries: alkaline, standard (carbon-zinc) or rechargeable (Ni-Cd, Ni-MH), or new and used batteries.
- Do not use damaged batteries.
- Insert batteries with the correct polarity.

- Do not short-circuit the battery terminals.
- Remove exhausted batteries from the toy.
- Remove batteries during long periods of non-use.
- Do not dispose of batteries in fire.
- Do not charge non-rechargeable batteries.
- Remove rechargeable batteries from the toy before charging (if removable).
- Rechargeable batteries are only to be charged under adult supervision.

Disposal of batteries and product



The crossed-out wheellie bin symbols on products and batteries, or on their respective packaging, indicates they must not be disposed of in domestic waste as they contain substances that can be damaging to the environment and human health.



The chemical symbols Hg, Cd or Pb, where marked, indicate that the battery contains more than the specified value of mercury (Hg), cadmium (Cd) or lead (Pb) set out in Battery Directive (2006/66/EC).

The solid bar indicates that the product was placed on the market after 13th August, 2005.

 Help protect the environment by disposing of your product or batteries responsibly.

For more information, please visit:

www.recycle-more.co.uk

www.recyclenow.com

With the VTech® Crazy Legs Learning Bug safety comes first:

To ensure your child's safety, the assembly of this product is an adult activity, not a child's activity.

Please ensure the small baby bug is locked into position before giving this toy to a child.

Assembly Instructions

1. Please remove the baby bug label and the paper insert beneath it to expose the hole in the unit, and keep them out of your child's reach.
2. Align the bottom of the baby bug with the hole in the unit. Push the baby bug into the hole until it clicks into place.

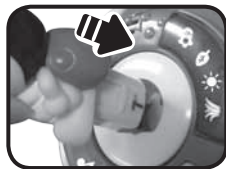

PRODUCT FEATURES

1. MODE SELECTOR SWITCH

To turn the unit **ON**, slide the **MODE SELECTOR SWITCH** to the **Learning** (📖) or the **Music** (🎵) mode position. To turn the unit **OFF**, slide the **MODE SELECTOR SWITCH** to the **(OFF)** position.



2. PULL-ALONG CORD

To convert the unit from a push toy to a pull toy, remove the pull cord from the battery compartment and thread it through the eyelet on the bottom of the bug. For your child's safety, we suggest you store the pull cord in the compartment until your child is walking.

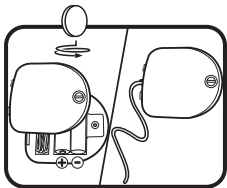

3. AUTOMATIC SHUT-OFF

To preserve battery life, the **VTech® Crazy Legs Learning Bug** will automatically power-down after approximately 45 seconds without input. The unit can be turned on again by pressing any button. Pulling the unit or spinning the baby bug does not turn it on.

ACTIVITIES

1. Press the spinning baby bug to hear talking phrases and fun sound effects in learning mode, and hear sing-along songs, talking phrases and fun sound effects in music mode. The baby bug will spin as the unit is pulled along. The lights will flash with the sounds.
2. Press the shape buttons or insert the shape pieces into related shape slots to learn shapes, numbers and nature objects in learning mode, and hear sound effects and melodies in music mode. The lights will flash with the sounds.

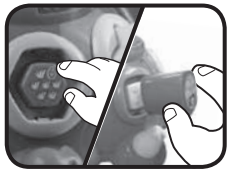

3. Press the music button to hear fun sound effects, talking phrases and questions about shapes or nature objects in learning mode, and hear melodies in music mode. The lights will flash with sounds.



4. Press the sound effect button to hear fun sound effects, talking phrases and questions about shapes or nature objects in learning mode, and hear fun sound effects and short tunes in music mode. The lights will flash with the sounds.



MELODY LIST

- | | |
|-----------------------------|--------------------------------------|
| 1. The Glow Worm | 7. I've Been Working on the Railroad |
| 2. London Bridge | 8. Pop! Goes the Weasel |
| 3. Shoo, Fly | 9. Twinkle, Twinkle, Little Star |
| 4. Mary Had a Little Lamb | 10. Hickory Dickory Dock |
| 5. Old MacDonald Had a Farm | 11. Hey, Diddle Diddle |
| 6. Polly Wolly Doodle | 12. Frere Jacques |

SUNG SONG LYRICS

SONG 1 (to the tune of 'Mulberry Bush')

Let's roll around, there's so much to see!
There's so much to learn, come learn with me!
Let's learn our shapes and numbers, too.
Let's take a learning journey!

SONG 2 (to the tune of ‘Yankee Doodle’)

Come, let's roll and play around.

Let's take a learning journey!

Shapes and numbers all around,

We have so much to see!

CARE & MAINTENANCE

1. Keep the unit clean by wiping it with a slightly damp cloth.
2. Keep the unit out of direct sunlight and away from any direct heat source.
3. Remove the batteries when the unit is not in use for an extended period of time.
4. Do not drop the unit on hard surfaces.

TROUBLESHOOTING

If for some reason the program/activity stops working or malfunctions, please follow these steps:

1. Please turn the unit OFF.
 2. Interrupt the power supply by removing the batteries.
 3. Let the unit stand for a few minutes, then replace the batteries.
 4. Turn the unit ON. The unit should now be ready to play again.
 5. If the product still does not work, replace with a new set of batteries.
- If the problem persists, please call our Consumer Services Department on 01235 546810 (from UK) or +44 1235 546810 (outside UK) and a service representative will be happy to help you.

IMPORTANT NOTE:

Creating and developing **VTech®** products is accompanied by a responsibility that we take very seriously. We make every effort to ensure the accuracy of the information, which forms the value of our products. However, errors sometimes can occur. It is important for you to know that we stand behind our products and encourage you to call our Consumer Services Department on 01235 546810 (from UK) or +44 1235 546810 (outside UK), with any problems and/or suggestions that you might have. A service representative will be happy to help you.



**CLASS 1
LED PRODUCT**



PRODUCT WARRANTY



Thank you for choosing this quality product from VTech. We hope it will bring many hours of entertainment, imaginative play and learning.

1. The product detailed above is covered by a one year warranty from the date of purchase, against any defects in materials or workmanship.
2. The product may be returned to the place of purchase. Alternatively the product can be returned to VTech Electronics Europe plc (see address below), with proof of purchase, without proof of purchase no replacement will be provided.
3. VTech Electronics Europe plc will examine the product and if it is found to be defective due to faulty materials or workmanship, will replace the product at their discretion.
4. If the product covered by this warranty is damaged due to misuse, modification or unauthorised repair, or because of faulty batteries, battery discharge or incorrect electrical connections, then this warranty becomes void.
5. This warranty is personal to the original purchaser and is not transferable.
6. Breakages to the LCD screen are not covered by the warranty.
7. Returns to VTech Electronics Europe plc should include a cheque or postal order for £1.50 towards the cost of return postage and packaging.
8. Products returned to VTech Electronics Europe plc, should be addressed as follows and packed carefully to avoid damage in transit (Please do not include batteries or adaptor).
Please include details of the fault together with your name and address.

VTech Electronics Europe plc, c/o Tablogix Limited, 200 Milton Park, Abingdon, Oxon OX14 4TA

THIS WARRANTY IS OFFERED AS AN EXTRA BENEFIT AND DOES NOT AFFECT CONSUMERS' STATUTORY RIGHTS.

This warranty is valid for the UK and Eire only. For products purchased outside the UK and Eire, please contact your local distributor or place of purchase.

